

新徐汇 New Xuhui Thriving Future

兴未来



徐汇投资指南
XUHUI
INVESTMENT
GUIDE



徐汇投资指南
XUHUI INVESTMENT GUIDE

Contents

05

Impression on Xuhui
Pooling Together Strengths

城区印象
荟萃徐汇实力

13

Industrial Layout
Envisioning a Future

产业布局
擘画千亿蓝图

23

Core Zones
Fostering a Vibrant Ecology

核心载体
共筑蓬勃生态

43

Resource Endowment
Harnessing a Multitude of Strengths

资源禀赋
聚合多重优势

49

A Prime Destination
for Global Investment

投资热土
尽享一流营商

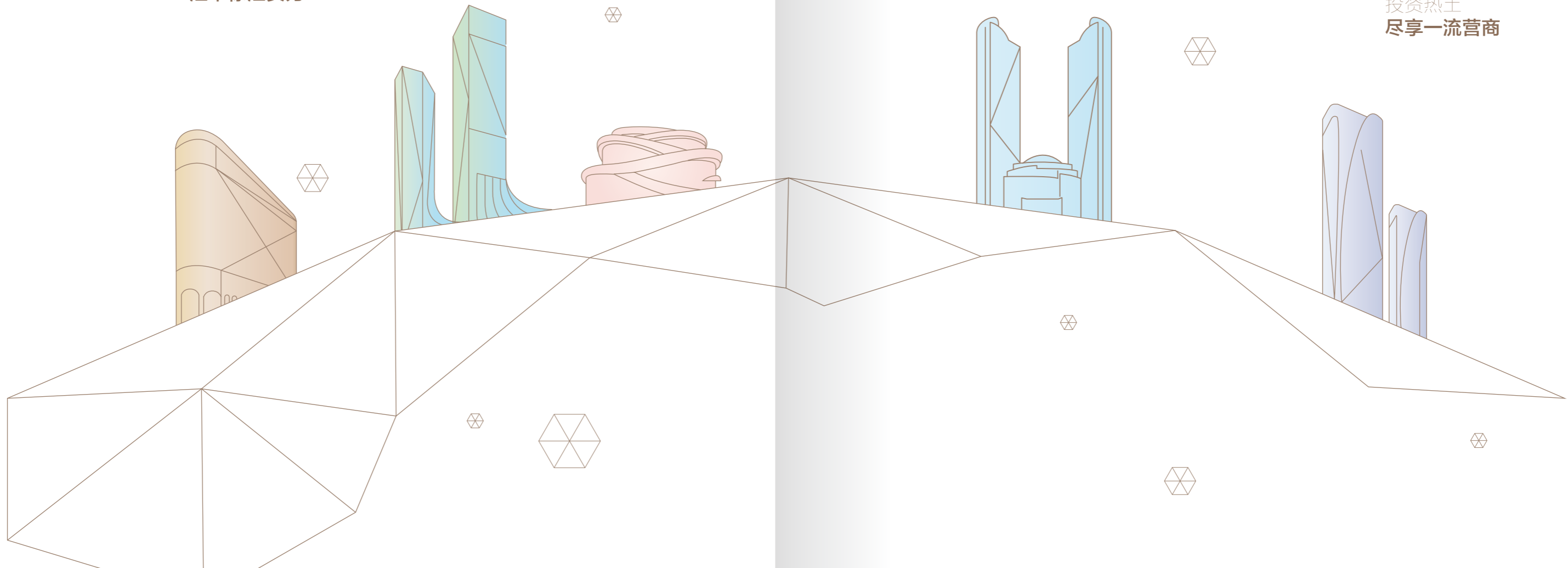

激昂奋进 徐汇向兴

Surging Ahead, Xuhui in Bloom

千载风云，激荡起黄浦江的壮阔波澜，
创新之力，推动着新徐汇的涅槃蜕变。

从龙华寺的悠长古韵，到徐家汇的都市鼎沸，
从衡复的中西交融，到西岸的科创火花，
在这片热土上，创新的种子，正在结出丰硕的果实。

徐汇之兴，不仅是一城之盛事，
更是时代之交响，是中华民族伟大复兴的壮丽乐章。

激昂奋进，徐汇向兴，时代之风，激扬征程。

让我们共同翻开徐汇这本厚重的史诗，
探寻发展脉络，领略城市风华，共谱未来新篇！

Over millennia, the grandeur of the Huangpu River is animated by stirring winds and clouds, mirroring the transformative energy of innovation that drives the rebirth of Xuhui, akin to a phoenix rising anew.

From the ancient allure of Longhua Temple to the dynamic urban beat of Xujiahui, from the fusion of Eastern and Western cultures in the Hengfu Historic and Cultural Area to the sci-tech innovation on the West Bund, on this fertile ground, the seeds of innovation bear rich fruit.

The rise of Xuhui is not merely a local celebration, but a symphony of the times and a magnificent part of the Chinese nation's rejuvenation.

Surging ahead, Xuhui in bloom on a new journey of this era.

Join us as we delve into the rich narrative of Xuhui, tracing the threads of its development, basking in the city's elegance, and together, crafting a new chapter for the future!

2023 徐汇经济图谱 Xuhui in 2023 by Figures

全年地区生产总值
2850⁺ 亿元
同比增长 **8.2%**
GDP: 285+ billion yuan, a YoY increase of 8.2%

区财政收入
250⁺ 亿元
同比增长 **11%**
Fiscal revenue: 25+ billion yuan, a YoY increase of 11%

社会消费品零售总额
1240 亿元
同比增长 **17.5%**
Total retail sales of consumer goods:
124 billion yuan, a YoY increase of 17.5%

全年实到外资
17⁺ 亿元
同比增长 **37.3%**
Annual foreign investment received:
1.7+ billion yuan, a YoY increase of 37.3%

跨国公司地区总部及外资研发中心
157 家
位居中心城区第一
157 MNC regional headquarters and
research centers, ranking first among
Shanghai's downtown districts

商品销售总额
8163 亿元
GMS: 816.3 billion yuan

规模以上工业总产值
918 亿元
Gross output from industrial enterprises
above designated size: 91.8 billion yuan

年税收超亿元楼宇
72 幢
72 buildings paying more than
100 million yuan in taxes

城区印象 汇萃徐汇实力

Impression on Xuhui, Pooling Together Strengths

徐汇，位于上海中心城区西南部，东北侧与黄浦区毗邻，东临黄浦江，与浦东新区隔江相望，西与闵行区分界，北与静安区、长宁区接壤，是进出南方各省市的陆上交通门户，轨交密度全市第二，黄浦江贯通岸线中心城区最长。

徐汇在新的历史机遇下焕发勃勃生机，对标世界一流城区，成为企业集聚、人才汇聚、创新积聚的首善之地。

Nestled in the southwest of downtown Shanghai, Xuhui shares a boundary with Huangpu District to the northeast. It faces the Huangpu River to the east, gazing over at the Pudong New Area, with Minhang District to the west and Jing'an and Changning districts to the north. Xuhui is a gateway to south China, ranking second in Shanghai by rail transit density. Notably, the district has the longest stretch of the Huangpu River coastline among the city's core districts.

Embracing a new chapter of historical opportunities, Xuhui is bursting with vitality, aspiring to global urban excellence. It has emerged as a prime district that harmoniously blends businesses, talent, and innovation.

占地面积约
54.93平方公里
Total area: Approx. 54.93 km²



区位核心
Core Location

区级财政收入
250+亿元
Fiscal revenue: 25+ billion yuan



经济繁荣
Economic
Flourishing

2023年全区地区生产总值同比增长8.2%以上，区级财政收入250+亿元，同比增长11%，“4+3+X”产业布局基础扎实、发展迅猛；品牌商贸、外资总部、科技创新等极具特色。

In 2023, Xuhui registered a projected GDP growth of over 8.2%, alongside a fiscal revenue surpassing 25 billion yuan, with a YoY increase of 11%. The district's robust "4+3+X" industrial layout lays a solid foundation for its rapid expansion, marked by distinctive branded commerce and trade, MNC headquarters, and sci-tech innovation.

常住人口约
111.48万人
Resident population: 1,114,800 people



人口繁盛
Population
Prosperity

徐汇占地面积54.93平方公里，下辖12个街道1个镇。截至2023年末，全区常住人口总数111.48万人，户籍常住人口为77.85万人，外来常住人口33.63万人，繁荣不息。

Spanning an area of 54.93 km², Xuhui administers 12 sub-districts and one town. As of the end of 2023, the district had a resident population of 1,114,800 people, including 778,500 registered residents and 336,300 non-local residents.

90分钟 覆盖长三角城市群

2小时 联动亚太经济圈

Reaching any corner of the Yangtze River Delta within 90 minutes
Fast and convenient transport to Asia Pacific cities

徐汇区是上海重要的交通核心。建设中的轨道交通直通浦东、虹桥两大枢纽；区内上海南站是上海铁路客运的南大门；“徐汇1小时交通圈”全面覆盖长三角核心腹地。

徐汇位居嘉定、青浦、松江、奉贤、南汇等区域的黄金交通中心点，辐射“五大新城”；铁路、航道、轨道、高架道路四通八达，无缝构筑主城与新城联动的繁华生活圈。来徐汇可以坐拥黄浦江、联通长三角、链接全世界。

Xuhui District is a hub in Shanghai's sprawling transport system. Its rail transit under construction connects to Pudong and Hongqiao international airports directly. The Shanghai South Railway Station in the district is considered the south gate to Shanghai by rail. A one-hour travel circle has been built between Xuhui and key areas of the Yangtze River Delta.

From Xuhui District one can easily reach any of the five new cities of Shanghai, namely Jiading, Qingpu, Songjiang, Fengxian, and Nanhui. The newly established cities and Shanghai's main zone are thus connected and conveniently accessible by rail, water, or expressway. In Xuhui, one can enjoy stunning vistas of the Huangpu River, access the Yangtze River Delta, and connect to the world beyond.



千年文脉赓续 岁月融汇中西

Spanning a Millennium,
Blending Eastern and Western Cultures

文化肇始 汇通中西

400多年前，明代著名科学家、政治家徐光启携欧洲传教士利玛窦，于此坐而论道、著书立说，开中西文化交流之先河，此地遂称为“徐家汇”，区名由此而得。

The Dawn of Culture, Bridging East and West

Over 400 years ago, Xu Guangqi, a renowned scientist and statesman of the Ming Dynasty, and European missionary Matteo Ricci engaged in intellectual discourse and co-authored some works, laying the groundwork for cultural exchanges between the East and the West. This led to the naming of "Xujiahui," signifying the birthplace of this district.

海纳百川 兼容并蓄

100多年前，海派文化在这里起源，“衡复风貌区”步步皆为历史，1000余幢优秀历史建筑与名人故居，镌刻着近代中国的独特思潮与风骨。

Embracing Diversity, A Tapestry of Cultures

Over a century ago, the Shanghai-style culture, or Haipai culture, began to thrive here. The Hengfu Historical Conservation Zone houses more than 1,000 heritage architectures and former residences of notable figures, etching distinctive ideologies of modern China.

优秀历史建筑与名人故居

1000+ 幢

1,000+ heritage architectures and former residences of notable figures

千年古刹 龙华一绝

1700多年前，融合了江南文化与佛家精神的龙华古寺巍然创立，在座上海地区规模最大、历史最悠久的古刹中，“龙华晚钟”余音悠长，“千年飞塔”风骨绵延，历经风雨，静观风云变幻。

Longhua Temple

Over 1,700 years ago, the Longhua Temple was established, embodying the rich Jiangnan culture intertwined with Buddhist ethos. As Shanghai's largest and most ancient temple, it boasts the lingering reverberations of the Longhua Evening Bell and the enduring presence of the Thousand-Year Pagoda. Through the ages, it has been silently observing the ever-changing tapestry of life.

历经
1700年
A span of 1,700 years

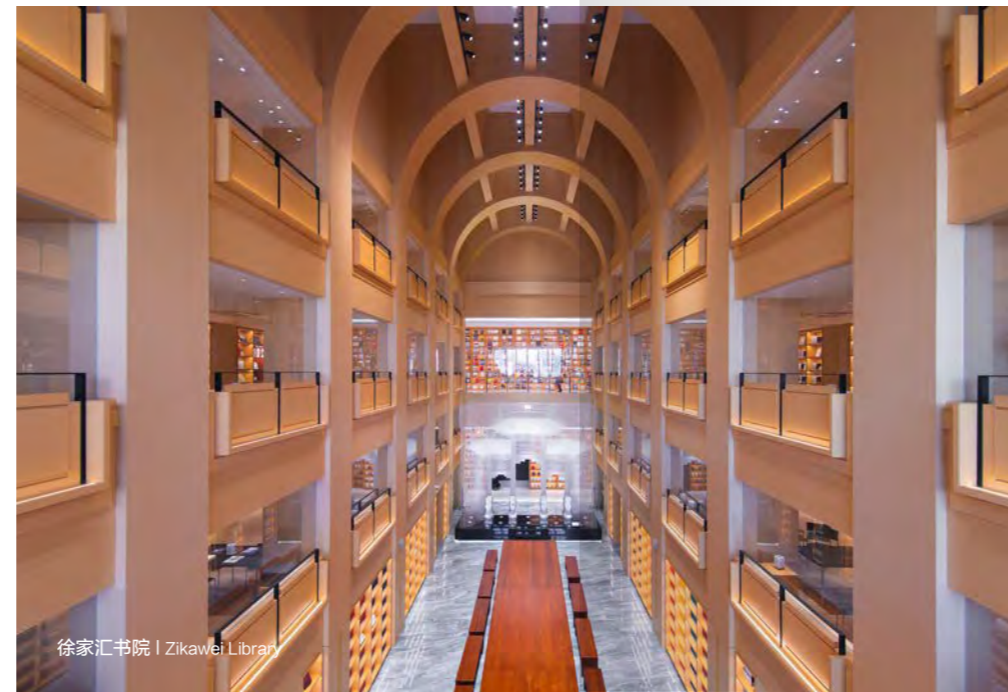

科技创新 徐汇正当时

Sci-Tech Innovation, Xuhui's Moment to Shine

科创图谱 亮点纷呈

徐汇区率先绘制科技创新图谱，高效构建“一谱综览、全景扫描、多维透视、动态追踪”的数字化图景，为打响科创绣带品牌和建设科创中心提供了科学的决策指引。

科创街区 应运而生

建设“西岸大模型创新生态、枫林生命健康、环交大人工智能、环华理生物材料、漕河泾数字技术、视听器械”等6个科创街区，不断满足科技社交、概念验证、成果转化等功能需求，为科技创新跨越挑战险关提供缓冲地带，为区域创新发展注入源动力。

The Rise of Sci-Tech Innovation Blocks

To cater to the evolving needs of sci-tech networking, proof of concept, and commercialization of innovations, Xuhui is set to develop six specialized sci-tech innovation blocks, including the West Bund Foundation Model Innovation Ecology, Fenglin Life and Health, SJTU-centered AI, Biological Materials around East China University of Science and Technology, Caohejing Digital Technology, and Audio-Visual Equipment Blocks. They are designed as a buffer for navigating challenges in sci-tech innovation, injecting vital energy into the district's innovative and transformative development.

Sci-Tech Innovation Landscape, A Spectrum of Highlights

Xuhui District pioneers in crafting a digital map for sci-tech innovation, which features "all-inclusive overview, panoramic insights, multi-dimensional perspectives, and dynamic tracking," offering scientific decision-making guidance for Xuhui's Sci-Tech Innovation Belt and fostering a robust Science and Innovation Center.

初步形成人工智能企业集群

700+家

700+ AI enterprise clusters

年均复合增长率

34.6%

CAGR: 34.6%

人工智能产业总产出

563亿元

Total output of the AI industry:
56.3 billion yuan

全球招募 创投联盟

徐汇区致力于科创生态的构建，打造高质量科创孵化器，培育更多“核爆点”，通过发布全球AI人才招募计划和设立“徐汇科创投资基金”，加速科技成果转化落地，推动科创源头的链接与跨越，引领区域高质量发展。

Venture Capital Alliance, A Global Call for Action

Dedicated to crafting a sci-tech innovation ecosystem, Xuhui is building top-tier incubators to catalyze more breakthroughs. Through the Global AI Talent Recruitment Program and the Xuhui Sci-Tech Investment Fund, the district accelerates the commercialization and application of scientific and technological achievements. The aim is to boost connections within the sci-tech innovation community and leapfrog to new heights, steering the district towards high-quality development.



产业布局 擘画千亿蓝图

徐汇区坚定不移锻长板、扬优势，优化产业生态和创新生态，巩固强化“4+3+X”产业基础，推动四大战略产业加速迈向千亿级，提高新赛道产业的集聚度和贡献度，打通转化-孵化-产业化的创新发展链条，加快壮大经济新动能，实现传统产业与新兴产业并序发展，跑出高质量发展的加速度。

Industrial Layout, Envisioning a Future

Committed to enhancing its strengths and competitive edge, Xuhui is optimizing its industrial and innovation ecosystems, consolidating its “4+3+X” industrial foundation, and witnessing its four strategic industrial clusters each on track to surpass RMB 100 billion. By elevating the density and contribution of industries on the new track and streamlining the innovation chain of transformation-incubation-industrialization, the district will speed up expanding new economic forces to facilitate parallel high-quality growth of traditional and emerging industries at a faster speed.

“4+3+X” 激活发展引擎

打造千亿级 四大战略产业集群

- ◆ 数字经济
- ◆ 生命健康
- ◆ 文化创意
- ◆ 现代金融

The “4+3+X” Industrial Layout,
Fueling the Engine of Growth

Creating Four 100 bn-yuan Industrial
Clusters of Strategic Importance

- ◆ Digital Economy
- ◆ Life and Healthcare
- ◆ Culture and Creativity
- ◆ Modern Finance

抢抓新赛道 激发新功能

- ◆ 元宇宙
- ◆ 绿色低碳
- ◆ 智能终端

Seizing New Opportunities to
Unlock New Potential

- ◆ Metaverse
- ◆ Green and Low-carbon Technologies
- ◆ Intelligent Devices

前瞻布局 先导产业

- ◆ 大模型
- ◆ 具身智能
- ◆ 合成生物

Pursuing Forward-looking
Layout for Leading Industries

- ◆ Foundation Model
- ◆ Embodied Artificial Intelligence
- ◆ Synthetic Biology



扫一扫
了解更多投资政策

Scan to
Learn More Investment Policies

聚焦全球资源配置

A Focus on the Allocation of Global Resources

总部经济 Headquarters Economy



企业排名不分先后
Corporate Ranking in Random Order

提高新赛道产业 集聚度和贡献度

Elevating the Density and Contribution of Industries on the New Track



前瞻布局 先导产业

Pursuing Forward-looking Layout to Steer Industries

模速空间创新生态社区 全国首个大模型专业孵化和加速载体

徐汇抢抓大模型在垂直领域形成爆发式应用的重要机遇期，市区共建、联手推出上海“模速空间”创新生态社区，一期位于徐汇滨江，近万方载体已投入使用，19家大模型企业率先入驻，成为大模型应用创新初创项目落地上海的第一站，将代表上海打造更具竞争力的世界级人工智能产业集群。

Mosu Space Innovative Ecological Community China's first specialized incubation and acceleration carrier for foundation model

Seizing the critical opportunity for explosive applications of foundation model in vertical domains, Xuhui, with support from the municipal government of Shanghai, has unveiled the Mosu Space Innovative Ecological Community. Its Phase I, situated in Binjiang, Xuhui, has seen nearly 10,000 m² of space operational, with 19 foundation model enterprises settled in. The community marks Shanghai's foray into groundbreaking projects in foundation model application innovation, and will develop a more competitive global AI industry cluster on behalf of Shanghai.

率先入驻大模型企业

50+家

50+ foundation model businesses settled in

产业总产出

563亿元

Total industrial output: 56.3 billion yuan

点燃“核爆点” 稳步向大模型产业高地进军

徐汇以大模型产业作为战略重点，打造算力调度、开放数据、评测服务、金融服务、综合服务五大功能平台，同时在空间载体、算力保障、备案辅导、应用场景等方面给予支持保障。通过不断放大平台牵引功能，为基础层、模型层、应用层各类企业创造更多合作机会。通过举办大模型行业企业家沙龙、研讨会等活动，营造大模型优质生态圈，推动大模型产业实现更水平的发展，为上海乃至全国的大模型产业作出更大的贡献。

Igniting the Catalyst for Growth Advancing Steadily to the Highland of the Foundation Model Industry

Strategically focused on the foundation model industry, Xuhui is expediting layout around its "1+1+5+N" functional system, while providing support in such fields as office spaces, computing power infrastructure, filing guidance, and application scenarios. By amplifying the platform's driving role, Xuhui has created a wealth of collaborative opportunities for businesses across foundational, model, and application layers. Through salons and seminars for entrepreneurs in the foundation model industry, the district has cultivated a premier ecosystem for foundation model, driving the industry toward higher-level development and making greater contributions to the foundation model industry in Shanghai and beyond.

大模型上下游企业和机构

300+家

300+ foundation model upstream and downstream businesses and institutions



聚焦“核爆点”区域优势 集结大模型企业成势

Capitalizing on Location Advantages, Assembling a Powerhouse of Foundation Model Businesses

企业排名不分先后
Corporate Ranking in Random Order

应用层 Application Layer

智慧医疗 Smart Medical Care UNITED IMAGING 联影医疗 推想科技 Inception PULSE 普生医疗 Airdoc 爱道康 AliveX 艾活信 微医 WeDoctor 全球医学影像 歌神科技 平安好医生 Taimel 泰美医疗科技	智慧金融 Smart Finance 中电金信 GreenTech 金融数据服务 DNECONNECT 益融股份 汇付天下 ChinaPay HYRON 宝付 Fairyland 同盾科技 JUZIX 聚信		
数字文娱 Digital Culture and Entertainment 腾讯游戏 Tencent Games 网易 NetEase www.163.com miHoYo UBISOFT FUNPLUS 完美世界 界面·财联社 WORLD	智慧城市 Smart City INESA 上海依世 万达信息 TERMINUS 特斯联 DATATOM 卓莱信息 51 WORLD	智能制造 Smart Manufacturing SmartMere 厨鼎科技 新核云 SMAWAVE 司通科技 SIPAI 上海自派 大制科技 Manulism INTESIM 英特仿真	其他 Others 巨量引擎 瑞数信息 松灵AI 智·感·应 凹凸出行 凹凸自动驾驶
智能硬件/智能终端 Smart Hardware / Smart Terminal mi oppo 龙旗 LONGCHEER EZVIZ 萤石 GoerTek partner* GARMIN COOCCO 酷开网络 傲基智能 BASEWIN COWA ROBOT 酷哇机器人 FITURE Droji 卓立科技 傲基智能 BASEWIN Damon	智能驾驶 Smart Driving eCARX 亿咖科 PATEO GEELY 极星汽车 斑马 COWA ROBOT 酷哇机器人 ZEEKR		

产品层 Product Layer

Technology Layer 技术层

计算机视觉 Computer Vision 腾讯优图 商汤 SenseTime SmartMere 厨鼎科技 依图 YITU XMOV 睿动视觉 EMDATA 数据科技 versa PIXSUR 30lab	自然语言处理 Natural Language Processing EMOTIBOT 情绪智能科技 云知声 出门问问 mobvoi 云译 思必驰 AISPEECH	RPA RPA 来也 Datatist UiPath	知识图谱 Knowledge Graph 明略科技 KGDATA
生态 Ecology Microsoft aws ARM CHINA Tencent 腾讯 Alibaba.com HUAWEI mi 字节跳动 GEELY 吉利控股集团	云服务 Cloud Services 腾讯云 TRANSWARP 星环科技 网宿科技 VirtAI Tech AI INESA 依世智能 电科华云	智能传感器 Smart Sensor SIPAI 巨灵电子 新跃联汇 KISTLER 捷通科技 捷通科技	智能芯片 Smart Chip 澜起 Fulihan Micron FourSemi 傅里叶 MEDIATEK ARM CHINA 依图 YITU FUSHICS 富思科技 行芯 PHLEXING 上海贝岭

Foundational Layer 基础层

核心载体共筑蓬勃生态

大徐家汇功能区

引领国际大都市的人文格调与科技浪潮

荟萃世界万象 阅尽都市繁华 这里就是上海中心

大徐家汇功能区面积11.2平方公里，以徐家汇商圈为中心，主要包括徐家汇、天平、湖南、枫林街道。北至淮海西路、华山路、长乐路，连通衡复风貌区，东至陕西南路、小木桥路，南至华容路、中山南二路，西至凯旋路，拓展至徐家汇体育公园，联动沿线学校等丰富的科创资源，推动商务、商业、文旅、体育、金融、科技等多要素多功能作进一步融合，使徐家汇作为中央活动区的功能更加复合，能级不断提升，加快形成承载上海“四大功能”的示范效应，打造上海国际大都市中央活动区。

ITC-徐家汇中心项目

打造上海中央活动区
世界级商圈的新地标

建筑面积: 88万平方米
竣工时间: 一二三期已建成,
2024年陆续竣工

Xujiahui ITC

A new landmark in Shanghai's world-class CAZ

Gross Floor Area: 880,000 m²

Time Of Completion:

One ITC, Two ITC, and Three ITC completed;
completion of the project expected in 2024



效果图 | Effect View

Core Zones, Fostering a Vibrant Ecology

Greater Xujiahui Functional Area

A cultural and technological beacon within an international metropolis

This vibrant heart of Shanghai is where global diversity meets urban opulence.

Spanning 11.2 km², the Greater Xujiahui Functional Area, anchored by the Xujiahui Business District, mainly encompasses Xujiahui, Tianping, Hunan, and Fenglin sub-districts. Bounded by West Huaihai Road, Huashan Road, and Changle Road to the north, it connects seamlessly with the Hengfu Historic and Cultural Area. To the east, it reaches South Shaanxi Road and Xiaomuqiao Road; to the south, it extends to Huarong Road and Second South Zhongshan Road; and to the west, it broadens to Kaixuan Road, stretching further to the Xujiahui Sports Park. This expansive area leverages its wealth of scientific and educational resources, such as schools along, to foster a deeper integration of business, commerce, culture, tourism, sports, finance, and science and technology. By enriching the functions of Xujiahui as a CAZ and elevating its energy level, Xuhui will expedite Xujiahui's demonstration effect in forming Shanghai's four functions and establish a CAZ within this international metropolis.



实景图 | Live View

港汇中心

地理位置: 虹桥路1号、虹桥路3号
办公面积: 13.6万平方米

Grand Gateway

Address: 1 Hongqiao Road, 3 Hongqiao Road
Office Area: 136,000 m²

徐家汇 Xujiahui



淮海路 Huaihai Road



环贸广场 上海中心地标级大型综合体

地理位置: 淮海中路999号
办公面积: 11.6万平方米

iAPM Square A large landmark complex in downtown Shanghai

Address: 999 Middle Huaihai Road
Office Area: 116,000 m²

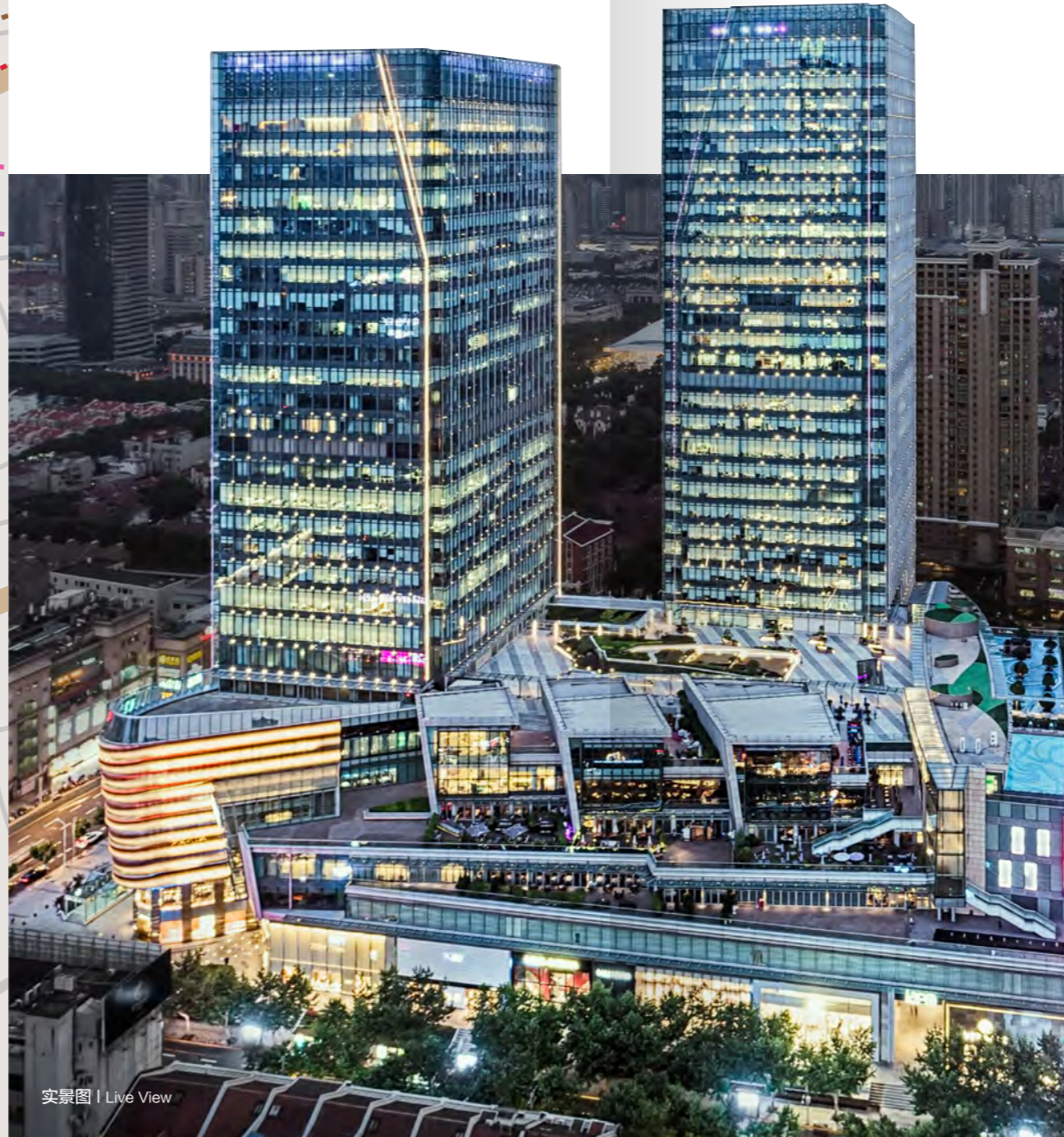

实景图 | Live View

嘉华中心

地理位置
淮海中路1010号
办公面积
6.5万平方米

K. Wah Center

Address: 1010 Middle Huaihai Road
Office Area: 65,000 m²



实景图 | Live View

世纪商贸

地理位置
长乐路989号
办公面积
8.9万平方米

The Center

Address: 989 Changle Road
Office Area: 89,000 m²



实景图 | Live View

淮海国际

地理位置
淮海中路1045号
办公面积
7.3万平方米

Huaihai International

Address: 1045 Middle Huaihai Road
Office Area: 73,000 m²



实景图 | Live View

西岸滨江功能区

同频世界级滨水区“科创绣带”未来可期

一港 一谷 一城 一场 一湾 一心 给世界一张上海科创名片

西岸滨江功能区位于徐汇区西南域，北至肇嘉浜路、中山南二路，东至龙腾大道望月路，南至景联路，西至龙吴路，面积9.4平方公里，主要包括斜土、龙华街道，以及长桥街道、华泾镇部分区域。西岸金融城项目是上海历史上最大的单一地产投资项目，比肩外滩、陆家嘴等世界级金融城市标杆。“一港一谷一城一场一湾一心”六大组团加速建设，四大产业和垂直领域的重量级项目、高能级平台、标杆性企业加速落地，西岸滨江功能区正在以形成具有国际影响力的“科创绣带”为目标，向经济高质量发展的强劲增长极稳步迈进。

- | | | | | | |
|---|--|---|--|---|---|
| <p>一港
西岸传媒港</p> <p>One Port:
West Bund Media Port</p> | <p>一谷
西岸数字谷</p> <p>One Valley:
West Bund AI Valley</p> | <p>一城
西岸金融城</p> <p>One City:
West Bund Financial City</p> | <p>一场
西岸热力秀场</p> <p>One Field:
West Bund Dynamic Field</p> | <p>一湾
西岸生命蓝湾</p> <p>One Bay:
West Bund Biomedical Bay</p> | <p>一心
西岸数智中心</p> <p>One Center:
West Bund AI Center</p> |
|---|--|---|--|---|---|

West Bund Riverside Functional Area

Benchmarked as a World-class Riverside Area
A Promising Sci-Tech Innovation Belt

One Port, One Valley, One City, One Field, One Bay, One Center
Present the world a sci-tech business card of Shanghai

Nestled in the southwest of Xuhui District, the West Bund Riverside Functional Area stretches from Zhaojiabang Road and Second South Zhongshan Road in the north to Wangyue Road along Longteng Avenue in the east, Jinglian Road in the south, and Longwu Road in the west. This area, covering an area of 9.4 km², primarily encompasses the Xietu and Longhua sub-districts, along with portions of Changqiao Street and Huajing Town. The West Bund boasts robust industrial clusters, highlighted by the West Bund Financial City, Shanghai's largest single real estate investment to date, on par with world-renowned financial hubs like the Bund and Lujiazui. It is witnessing accelerated construction of numerous major projects across six industrial clusters. Prominent projects, high-energy platforms, and benchmark enterprises within four major industries and vertical fields are rapidly being established. With a goal to create a globally influential Sci-Tech Innovation Belt, the West Bund Riverside Functional Area is making strides towards a powerhouse of high-quality economic development.

西岸

West Bund





效果图 | Effect View

西岸金融城

新一代世界级金融城
都市进化新范本

地理位置: 东至瑞金路, 南至瑞金路,
西至东安路, 北至龙华中路

建筑面积: 170万平方米,
竣工时间: 2024-2027年陆续竣工

West Bund Financial City

A new-generation world-class financial city
A new model of urban evolution

Location:
Ruining Road in the east, Ruining Road-Longteng
Avenue in the south, Dong'an Road in the west,
Middle Longhua Road in the north

Gross Floor Area: 1.7 million m²
Completion expected in 2024-2027



效果图 | Effect View

西岸数字谷

打造以人工智能为核心的
数字经济产业集群

地理位置: 云锦路、龙耀路、丰谷路、
龙腾大道-云锦路围合区域

建筑面积: 120万平方米, 部分建成投用

West Bund AI Valley

Designed to be an AI-centered cluster
for the digital economy

Location:
Yunjin Road, Longyao Road, Fenggu Road, and
Longteng Avenue-Yunyao Road

Gross Floor Area:
1.2 million m², partly completed and operational

滨江复星中心 西岸起笔处 独栋定制 全球卓越的总部舞台

地理位置: 东至瑞金路, 南至龙华中路, 西至兆丰路, 北至中山南二路
建筑面积: 22万方; **竣工时间:** 2025年整体竣工

Xuhui Riverside Fosun Center

A custom-built, single structure on the West Bund,
a stage for global excellence

Location:
Ruining Road in the east, Middle Longhua Road in the south, Zhaofeng
Road in the west, Second South Zhongshan Road in the north

Gross Floor Area: 220,000 m²
Completion expected in 2025



效果图 | Effect View

星扬西岸中心 定义地标建筑新高度, 彰显前沿生活新方式

地理位置: 龙耀路175号
建筑面积: 17万平方米, 已竣工

Lumina
The tallest skyscraper in Xuhui Waterfront that provides prime
office space and retail sections

Address: 175 Longyao Road
Gross Floor Area: 170,000 m², completed



实景图 | Live View

西岸传媒港 打造以艺术传媒为引领的文化创新创业集群

地理位置: 龙耀路、龙腾大道南侧
建筑面积: 110万平方米, 已建成投用

West Bund Media Port
An art- and media-centered hub for cultural and creative startups

Location: Longyao Road, south to Longteng Avenue
Gross Floor Area: 1.1 million m², completed and operational



实景图 | Live View

龙华万科中心 徐汇西岸人文商务综合体

地理位置: 龙华路2678号-2716号
建筑面积: 6.65万平方米
交付时间: T2、T3、T4、T5幢已建成, T1幢2024年二季度建成

Longhua Vanke Center

A business complex in the West Bund

Address: 2678-2716 Longhua Road
Gross Floor Area: 66,500 m²
T2, T3, T4 and T5 completed, T1 expected to be completed by 2024Q2



实景图 | Live View

漕开发拓展功能区

锚定前沿经济 科创力量 前所未有

“漕开发”实力迭代 激活上海产业创新动能

位于徐汇区西部的漕开发拓展功能区，面积为12.49平方公里。北至吴中路，东至凯旋路、漕溪路、柳州路，南至沪闵路，西至莲花路、虹梅路，主要覆盖虹梅街道、田林街道和康健街道。围绕实现区城市更新中心实体化运作，并致力于厚植科创土壤，漕开发拓展功能区大力推动城市更新重点项目，如航天、越界、元创未来中心、鑫耀中城等，目标是成为一个科技创新驱动、产城融合的国际社区，并将成为集中展示上海创新浓度、产出强度、经济密度的产业创新增长极。

Expanded Functional Area in Caohejing Hi-Tech Park

Anchoring the Frontier Economy
Harnessing Unmatched Sci-Tech Innovation

Caohejing Hi-Tech Park Activates Shanghai's Industrial Innovation

Situated in the western part of Xuhui District, the Expanded Functional Area in Caohejing Hi-Tech Park spans 12.49 km². Bounded by Wuzhong Road to the north, Kaixuan Road, Caoxi Road, and Liuzhou Road to the east, Humin Road to the south, and Lianhua Road and Hongmei Road to the west, it encompasses the Hongmei, Tianlin, and Kangjian sub-districts. Focused on materializing the urban renewal center and deeply cultivating a fertile ground for sci-tech innovation, this area vigorously propels key urban renewal projects such as Aerospace, Golden Union Park, CHJ Meta-Park, and Galaxy Midtown. Aiming to evolve into an international community propelled by sci-tech innovation for integration of urban development and industrial growth, this area is poised to become a pivotal hub that features an ongoing elevation in innovation concentration, economic density, and industrial scale.





鑫耀中城
 超级城市综合体，融商业、办公、住宅及文化剧场于一体

地理位置: 苍梧路6-12号
建筑面积: 65万平方米
竣工时间: 一期已建成，2024-2025年陆续竣工

Galaxy Midtown
 A mega urban complex of shopping malls, offices, residential area, and theater(s)

Address: 6-12 Cangwu Road
Gross Floor Area: 650,000 m²
 Phase I completed; completion of the project expected in 2024-2025

效果图 | Effect View



效果图 | Effect View

越界·锦和尚城
 徐汇内中环城市更新标杆

地理位置: 田林路140号
建筑面积: 30万平方米
竣工时间: 一期已建成，2024年陆续竣工

Golden Union Park
 A leading old-area transformation project in Xuhui District

Address: 140 Tianlin Road
Gross Floor Area: 300,000 m²
 Phase I completed; completion of the project expected in 2023-2024



效果图 | Effect View

航天科技城
 高能级的科技创新园区
 高品质的产城融合示范区

地理位置: 东至桂林路、南至宜山路
 西至苍梧路、北至钦江路
建筑面积: 约60万平方米
竣工时间: 2025年6月底

Shanghai Aerospace Science and Technology City
 A high-energy sci-tech innovation park
 A premium demonstration zone for the integration of urban development and industrial growth

Location:
 Guilin Road in the east, Yishan Road in the south,
 Cangwu Road in the west, Qinjiang Road in the north
Gross Floor Area: Approx. 600,000 m²
 Completion expected by the end of June 2025



效果图 | Effect View

徐汇中城功能区

让产业与城市相融 绘就上海未来新图景

打造“环华理”创新经济圈 上海产城融合新标杆

徐汇中城功能区北至漕宝路、沪闵路，东至龙吴路，南至淀浦河，西至虹梅路，面积14.68平方公里，覆盖漕河泾、凌云、长桥街道，是徐汇区东西北交汇之地。该功能区将注重强化城区核心功能布局，推进南北交通路网贯通，研究地铁上盖开发，打造“环华理”创新经济圈，积极承接北、东、西三个功能区的产业溢出。突出南北枢纽功能，旨在成为产城融合发展和现代都市产业的引领示范区，推动徐汇区可持续发展。



Xuhui Midtown Functional Area

Blending Industrial Growth and Urban Development
Charting a New Future for Shanghai

Creating an Innovative Economic Circle surrounding the East China University of Science and Technology
A New Benchmark for Shanghai's Integration of Urban Development and Industrial Growth

The Xuhui Midtown Functional Area, covering an area of 14.68 km², lies at the crossroads of Caobao Road and Humin Road to the north, Longwu Road to the east, Dianpu River to the south, and Hongmei Road to the west, enveloping the Caohejing, Lingyun, and Changqiao sub-districts. Focusing on the layout of core functions in the urban area, it runs through the north-south traffic network, taps developments atop subway stations. By highlighting its key role as a north-south hub, it is positioned as a beacon for integrating urban development and industrial growth and the modern urban industries, thereby steering Xuhui District towards a path of sustainability.

徐汇中城 Xuhui Midtown





效果图 | Effect View



效果图 | Effect View

徐汇万科中心
万科投资最大的商业地产项目

地理位置: 南宁路1000号、定安路55号
建筑面积: 43万平方米
竣工时间: 一二期已建成, 三期2023年完成竣工备案

Vanke Center Xuhui
Vanke's largest investment in commercial property

Address: 1000 Nanjing Road, 55 Ding'an Road
Gross Floor Area: 430,000 m²
Phase I and Phase II completed; completion of Phase III expected in 2023

枫林国际 汇创谷
C65科研用地, 生命健康产业市区研发新高地

地理位置: 武宣路9号
建筑面积: 近10万方

Maplewood International Venture Valley
A site for C65 scientific research and a new R&D hub for life and health industry in downtown Shanghai

Address: 9 Wuxuan Road
Gross Floor Area: Approx. 100,000 m²



效果图 | Effect View



效果图 | Effect View

华泾门户功能区

卓然新生 新中心蓄势待发

“五宜新华泾” 下一代城市副中心

华泾门户功能区位于徐汇区南部，与闵行区交界，包括华泾镇全域(除滨江带)，面积7.27平方公里。华泾镇聚焦“新产业”“新经济”“新交通”“新生态”“新治理”“新家园”“新群体”“新生活”，全力打造“五宜新华泾”。聚焦人工智能、生物医药、高端制造等领域，加强与漕开发、滨江产业联动。推进一批基础设施、教育、养老、卫生项目建设，高标准建设环城生态公园带，进一步完善产业、公共配套、生态环境等功能，对标城市副中心标准，打造为一座科创重镇和生态新城。

Huajing Gateway Functional Area

A New Life
A New Center Poised for Rise

A New Huajing for Living, Working, Travelling, Study, and Healthcare
The Next-generation Sub-City Center

Located in southern Xuhui and adjacent to Minhang District, the Huajing Gateway Functional Area, covering an area of 7.27 km², encompasses the entirety of Huajing Town (excluding the riverside area). Focusing on new industries, new economy, new transport, new ecology, new governance, new home, new communities, and new lifestyle, the Huajing Town is committed to creating a new Huajing for living, working, travelling, study, and healthcare. It prioritizes areas like AI, biopharmaceuticals, and high-end manufacturing by enhancing synergies with the Caohejing Hi-Tech Park and riverside industries. A series of projects in infrastructure, education, elder care, and health are being advanced to construct a high-standard urban ecological park belt. These efforts aim to augment the zone's industrial, public service, and ecological functionalities, aligning with the criteria for a city's sub-center and transforming it into a hub of sci-tech innovation and a model for new urban ecology.





效果图 | Effect View

北杨人工智能创新中心
具有全球影响力的人工智能产业生态集聚区

地理位置: 东至长华路、南至外环线、西至老沪闵路、北至淀浦河
建筑面积: 100万平方米
竣工时间: 2024-2026年陆续竣工

Beiyang AI Town
A globally influential AI eco-hub

Location:
Changhua Road in the east, Outer Ring in the south,
Laohumin Road in the west, and Dianpu River in the north
Gross Floor Area: 1,000,000 m²
Completion expected in 2024-2026



效果图 | Effect View

华之门
双轨之上的多元业态规划
超大体量综合体开发

地理位置: 东至景洪路，南至兴南东路
西至曹联路，北至规划绿化
建筑面积: 130万平方米

Huazhimen (Hua's Gate)
A multi-functional mega complex where two metro lines converge

Location:
Jinghong Road in the east, East Xingnan Road
in the south, Caolian Road in the west, and
planned greenery in the north
Gross Floor Area: 1,300,000 m²

西岸生命蓝湾
打造研发、临床、制造于一体的
生命健康产业创业高地

地理位置: 华泾南部地区
建筑面积: 50万平方米

West Bund Biomedical Bay
An incubation hub for R&D,
clinical, and manufacturing businesses
in the life and health industry.

Location: South Huajing Town
Gross Floor Area: 500,000 m²



效果图 | Effect View

资源禀赋 聚合多重优势

徐汇坐拥得天独厚的城市资源，商业繁华、科教繁荣、文娱繁盛，都市生活万般美好，尽在一城。
“大院大所大校大企大园”，厚植科创发展优势，努力打造上海高质量发展的强劲增长极。

Resource Endowment, Harnessing a Multitude of Strengths

Xuhui boasts unparalleled urban resources, encapsulating the essence of commercial vibrancy, academic and scientific excellence, and cultural and entertainment richness. This district is the epitome of urban living at its finest, offering a comprehensive suite of amenities and experiences within a single city. Home to a number of hospitals, research institutes, universities, corporations, and parks, Xuhui is deeply committed to cultivating a solid foundation for innovation and scientific advancement, with the goal of transforming Xuhui into a powerful engine for Shanghai's high-quality development.

商业繁华 热力勃发

徐汇商业人气卓绝，拥有大量商业载体，商业氛围浓厚。这里不仅是顶级商圈、总部高地，还是“全球新品首发地示范区”和“知名本土消费品牌聚集区”。在徐汇，丰富多样的购物场所和强大的消费品牌集聚效应，使其成为独特而吸引人的世界一流的商业目的地。无论是消费者、品牌商还是投资者，都能充分领略徐汇的商业魅力。

A Vibrant Commercial Hub, Unleashing Dynamic Energy

Xuhui stands out for its exceptional commercial vitality, boasting a large number of commercial carriers and a strong business atmosphere. This district is renowned not just as a premier shopping and corporate headquarters hub, but also as a showcase area for global new product debuts and a hotspot for celebrated local consumer brands. With its rich array of shopping options and powerful aggregation of consumer brands, Xuhui has emerged as a distinctive and compelling global commercial destination. Here, consumers, brand merchants, and investors alike can immerse themselves in Xuhui's commercial allure.



科研深厚 创新沃土

汇集国家级市级
科研机构和重大平台
160+家
160+ state- and
municipal-level research
institutions and platforms

每万人
发明专利拥有量
168+件
168+ high-value patents
per 10,000 people

生活或工作
在徐汇的院士
124位
124 CAS and CAE
academicians live or
work in Xuhui

高新技术企业
754家
754 high-tech firms

徐汇是国家双创示范基地和上海科创中心重要承载区，拥有国家及市级科研平台160余个，高新技术企业754家，并聚集了微软亚研院、亚马逊AWS等国际创新平台，更有124位院士青睐于徐汇的独特魅力而选择定居或工作于此。

截至2023年底，徐汇区每万人发明专利拥有量为168.13件，连续多年拔得头筹，位居全市前列。

Top Research Institutes

As a state-level innovation and entrepreneurship demonstration base and carries core functions of Shanghai Technology Innovation Center, Xuhui is home to over 160 state- and municipal-level research institutions and major platforms, 754 high-tech firms, and global innovation platforms such as Microsoft Research Asia and Amazon Web Services (AWS). And a total of 124 CAS and CAE academicians have chosen to live or work in Xuhui for its unique allure.

As of the end of 2023, Xuhui has topped its counterparts in Shanghai for years in terms of average invention patent ownership, reaching 168.13 patents per 10,000 people.

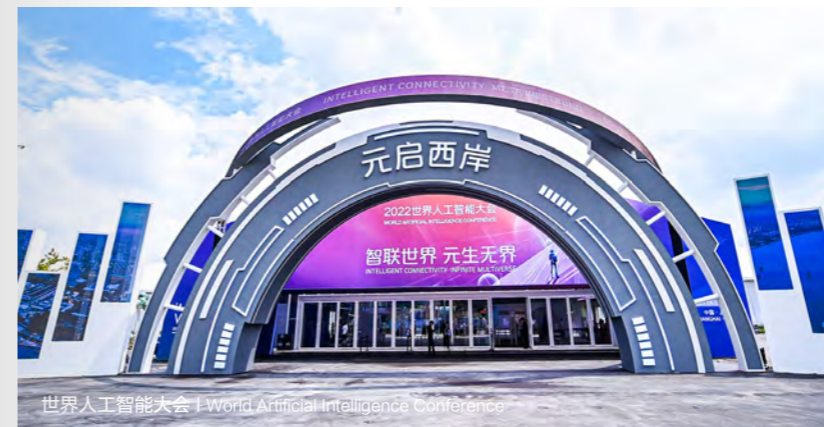

教化培育 名校璀璨

徐汇区传承百年教育历史沉淀，努力打造与一流中心城区相匹配的一流教育。从幼小初高到高等教育，徐汇师资力量雄厚，教研水平精良，是上海乃至全国教育领域的标杆之一。其中享誉全国的世外小学，汇师小学、上海中学、华育初中、南洋模范中学等皆坐落于此，更有上海交通大学、复旦大学医学院、华东理工大学、上海音乐学院等18所知名高等学府璀璨林立。

知名高等院校

18所

18 renowned institutions of higher education



上海交通大学 | Shanghai Jiao Tong University



上海市世界外国语小学 | Shanghai World Foreign Language Primary School

Rich Educational Resources

Xuhui District, with its century-old legacy in education, is committed to providing top-tier education that aligns with the standards of a premier urban center. Spanning from early childhood through to higher education, Xuhui boasts a formidable teaching faculty and exceptional research and teaching capabilities, setting a benchmark in education not just in Shanghai but across the nation. Esteemed institutions include Shanghai World Foreign Language Primary School, Hui Shi Primary School, Shanghai High School, Shanghai Huayu Private Middle School, and Nanyang Model High School. Eighteen famous universities and colleges are located here, including Shanghai Jiao Tong University, Shanghai Medical College of Fudan University, East China University of Science and Technology, and Shanghai Conservatory of Music.



上海南洋模范中学 | Nanyang Model High School



复旦大学附属中山医院 | Zhongshan Hospital Affiliated to Fudan University

医疗丰沛 康佑万家

徐汇区医疗卫生水平全市领先、全国知名，汇集上海四分之一的三甲等医院，如中山医院、肿瘤医院、胸科医院、第六人民医院等。嘉会国际医院是上海投资规模最大的中外合资医院，为市民提供高质量的医疗服务。随着南部医疗中心、徐汇老年护理医院，以及4大社区卫生服务中心相继竣工并投入使用，充分满足了区域患者的医疗服务需求，为市民的健康保驾护航。

Abundant Medical Facilities

Xuhui District sets a benchmark in healthcare within Shanghai and enjoys national acclaim, hosting a quarter of Shanghai's level IIIA hospitals in Xuhui District, including Zhongshan Hospital, Fudan University Shanghai Cancer Hospital, Shanghai Chest Hospital, and Shanghai Sixth People's Hospital. Jiahui International Hospital is a joint venture with the largest foreign fund in Shanghai, offering high-quality medical services. With the Southern Medical Center, Xuhui Elderly Care Hospital, as well as four major community health service centers completed and put into use, Xuhui fully meets the medical service needs of patients, safeguarding the well-being of the community.

三级甲等医院

8家

8 level IIIA hospitals

重点人群家庭医生签约覆盖率达

80%

80% coverage of family doctor signing rate in key groups



徐汇区南部医疗中心 | Xuhui Southern Medical Center

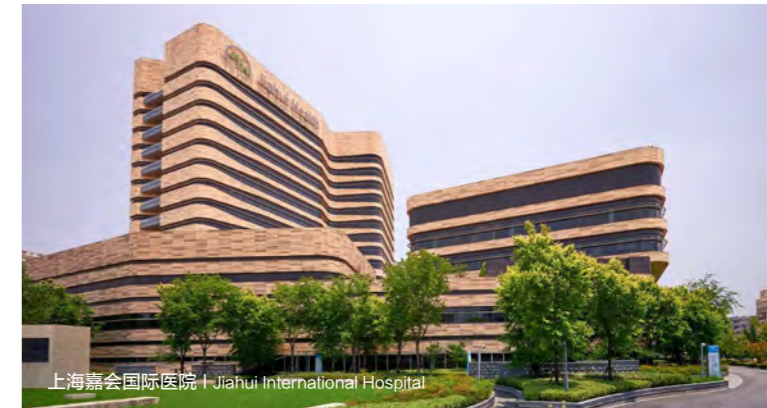

上海嘉会国际医院 | Jiahui International Hospital



中国福利会国际和平妇幼保健院
International Peace Maternity & Child Health Hospital of China Welfare Institute



上海交响乐团 | Shanghai Symphony Orchestra



SAGA光明之城剧场 | SAGA City of Light



上海咖啡文化周 | Shanghai Coffee Culture Week



上音歌剧院 | Shanghai Opera House

活力文旅 魅力人文

上海80%的文化单位和文艺院团聚集于徐汇区，如上海图书馆、中国画院、上海电影制片厂、上海交响乐团等。拥有龙华庙会、西岸国际咖啡生活节、西岸文化艺术季、上海城市空间艺术季、上海国际艺术品交易周等文化IP。

Fascinating Culture and Tourism

Xuhui District hosts 80% of Shanghai's cultural and art institutions, such as the Shanghai Library, China National Academy of Painting, Shanghai Film Studio, and Shanghai Symphony Orchestra. The district is also home to cultural IPs like Longhua Temple Fair, West Bund International Coffee And Lifestyle Festival, Art West Bund, Shanghai Urban Space Art Season, and Shanghai International Artwork Trade Week.

全市文化单位和文艺院团占比

80%

80% of Shanghai's cultural and art institutions



西岸美术馆 | West Bund Museum

体育蓬勃 蔚然成风

徐汇是目前上海设施设备最齐全的体育文化聚集区，现有体育场地数量3308个，体育场地总面积153.72万平方米，人均体育场地面积1.399平方米，列中心城区第二位，如上海体育场、上海体育馆、上海游泳馆、万体汇综合馆等。2023年，FISE世界极限运动巡回赛上海站落户西岸，为徐汇体育事业发展增添了一抹亮色。

Booming Sports

Xuhui is currently the most well-equipped sports and cultural gathering area in Shanghai, with 3,308 sports venues such as Shanghai Gymnasium, Shanghai Natatorium, and the Complex, totaling 1,537,200 m² or 1.399 m² per capita, ranking second among the districts in downtown Shanghai. In 2023, the FISE World Series at Shanghai took place in West Bund, adding a bright spot to the development of the sports industry.

现有体育场地数量

3308个

3,308 sports venues

体育场地总面积

153.72万平方米

1,537,200 m² of sports venues



上海国际马拉松 | Shanghai International Marathon



徐家汇体育公园 | Xujiahui Sports Park



“漕河泾杯”运动会 | Caohejing Cup Games

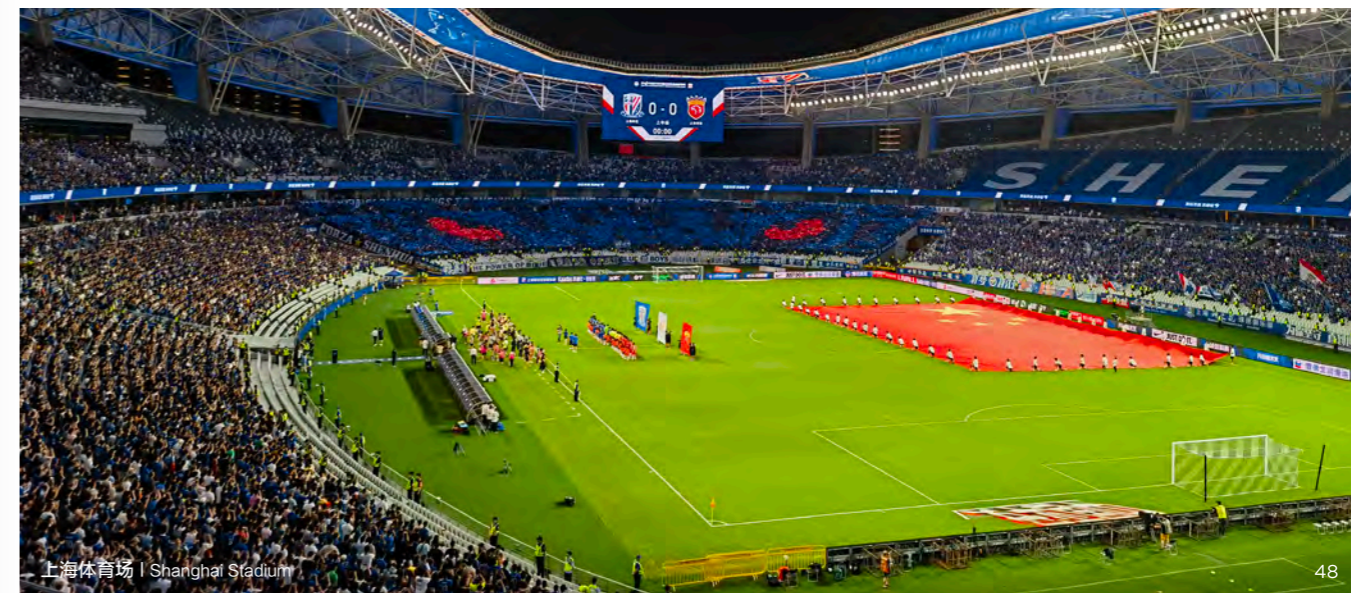

上海体育场 | Shanghai Stadium

投资热土 尽享一流营商

全球投资青睐之地

徐汇区优越的投资环境和区域优势，得到了新加坡、香港、日本、德国、法国、比利时等地各大重点企业的关注与认可，多次受邀来徐汇参观考察，成为了徐汇“朋友圈”的友好伙伴。在第六届进博会、“投资上海·全国行”上，徐汇展示出独特的招商吸引力，成为许多企业投资的优选目的地。

A Prime Destination for Global Investment

A Hub for Global Investment

Xuhui District's exceptional investment climate and strategic regional benefits have garnered attention and endorsement from key businesses across Singapore, Hong Kong (China), Japan, Germany, France, Belgium, and more. They have been invited to visit Xuhui several times, forging a strong alliance within the district's international "circle of friends." At events such as the 6th China International Import Expo and the Invest Shanghai National Tour, Xuhui has showcased its distinctive appeal to investors, positioning itself as a key focus for business ventures.

主流媒体瞩目之地

徐汇创立了“1+4+6+X”投促宣介品牌，得到央视、人民日报、经济日报、央广网、上海电视台、学习强国等主流媒体的专题报道和密集推广，让更多企业了解了徐汇政策、产业环境、项目伙伴等优势，徐汇已经成为上海的一张闻名于世的投资名片。

企业人才向往之地

徐汇区积极落实优化营商环境6.0版方案，完善企业全生命周期服务体系，有求必应、无事不扰，让每家企业都感受到“徐汇速度”“徐汇温度”。实施更国际化的人才政策，发挥教育、医疗、文化等资源优势，满足人才安居、子女就学等需求，栽好梧桐树，引得凤凰来。

A Magnet for Mainstream Media Attention

Xuhui has launched the "1+4+6+X" investment promotion brand, gaining featured coverage and extensive promotion from mainstream media including CCTV, People's Daily, Economic Daily, CGTN, Shanghai TV, and Xuexi Qiangguo. This has amplified corporate awareness of Xuhui's policies, industrial environment, and partnership opportunities, elevating Xuhui to a globally recognized investment destination within Shanghai.

A Desirable Locale for Corporate Talen

In its pursuit of enhancing the business environment to version 6.0, Xuhui District has refined its full life-cycle corporate service system, ensuring responsiveness and non-intrusiveness, thereby introducing enterprises to the "Xuhui Speed" and "Xuhui Warmth." By adopting more international talent policies and leveraging its strengths in education, healthcare, and culture, Xuhui aims to fulfill the living and educational needs of talents and their families, effectively attracting top talent like a phoenix to its welcoming boughs.



营商资源服务机构

Business and Investment Services

徐汇区投资促进办公室 上海市徐汇区营商服务中心(企业服务中心)

隶属徐汇区人民政府, 是负责徐汇区招商引资、投资促进、企业服务等营商服务工作的职能机构。

地址: 上海市漕溪北路366号1号楼8楼
联系电话(总机): 021-64872222



上海徐汇



徐汇投促

Investment Promotion Office of Xuhui District Business Service Center of Xuhui District (Enterprise Service Center)

The functional organ responsible for business attraction, investment promotion, and enterprise services under the People's Government of Xuhui District

Address: 8/F, Bldg. 1, 366 North Caoxi Road
Tel: 021-64872222



第二分中心

区科委、虹梅街道、漕河泾街道、枫林街道、城投集团、枫林集团

地址: 徐汇区桂箐路65号新研大厦1502室
联系电话: 021-64950310

No. 2 Sub-center

Science and Technology Commission of Xuhui District, Hongmei Sub-district, Caohejing Sub-district, Fenglin Sub-district, Chengtou Group, Fenglin Group

Address: Room 1502, Xinyan Building, 65 Guijing Road, Xuhui District
Tel: 021-64950310



第三分中心

区文旅局、区金融办、龙华街道、斜土街道、西岸集团、徐汇资本

地址: 徐汇区云锦路700号西岸智塔西塔楼31楼
联系电话: 021-64171399

No. 3 Sub-center

Xuhui District Culture and Tourism Bureau, Xuhui District Finance Office, Longhua Sub-district, Xietu Sub-district, West Bund Group, Xuhui Capital

Address: 31/F, AI Tower, 700 Yunjin Road, Xuhui District
Tel: 021-64171399



第四分中心

区投促办、田林街道、康健街道、长桥街道、凌云街道、新徐汇集团

地址: 徐汇区钦州路770号
联系电话: 021-64223778

No. 4 Sub-center

Xuhui District Investment Promotion Office, Tianlin Sub-district, Kangjian Sub-district, Changqiao Sub-district, Lingyun Sub-district, New Xuhui Group

Address: 770 Qinzhou Road, Xuhui District
Tel: 021-64223778

第一分中心

区商务委、徐家汇街道、湖南街道、天平街道、徐家汇商城集团、徐房集团

地址: 徐汇区南丹东路106号2楼
联系电话: 021-64471791

No. 1 Sub-center

Xuhui District Commission of Commerce, Xujiahui Sub-district, Hunan Sub-district, Tianping Sub-district, Xujiahui Centre Group, Xu Fang Group

Address: 2/F, 106 East Nandan Road, Xuhui District
Tel: 021-64471791



第五分中心

华泾镇

地址: 徐汇区龙吴路2443号
联系电话: 021-54821818-3163、021-33638615

No. 5 Sub-center

Huajing Town

Address: 2443 Longwu Road, Xuhui District
Tel: 021-54821818-3163, 021-33638615

乘势并进 徐汇向兴

当时代的东风，拂过这方热土，
当世界的目光，瞩目这座城市，
徐汇，凭借其丰沛的资源、独特的区位、领先的产业，
正敞开怀抱，热切地迎接全球的人才与企业。
在这里，处处机遇无限，处处生机蓬勃。
徐汇愿与你一起，携手并进，
乘势而行，徐写辉煌！



航天科技城 | Shanghai Aerospace Science and Technology City

西岸数智中心 | West Bund AI Center

徐家汇六百更新项目
Xujiahui No. 6 Department Store Urban Renewal Project

西岸国际会展中心 | West Bund International Convention Center

Riding the winds of progress Xuhui ascends

As the era's favorable winds sweep across this vibrant land,
and as the world's gaze turns towards this city,
Xuhui stands ready, its arms wide open. Blessed with rich resources, a strategic position, and forefront industries,
it eagerly welcomes global talents and businesses.
In Xuhui, the potential is boundless, and vitality abounds in every corner.
Together with you, Xuhui is set to stride into the future, leveraging this momentum to craft a shared legacy of success!